

6

5

4

3

2

1

REVISION					
ZONE	REV	DESCRIPTION	DATE	CHANGED BY	APPROVED
	B	ECN-0926: UPDATE PN CONFIG TABLE	03/18/2026	SLI	WLI

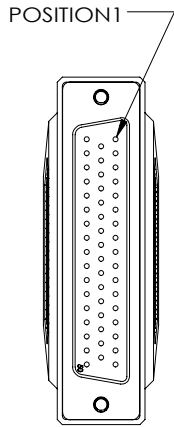

"P1"

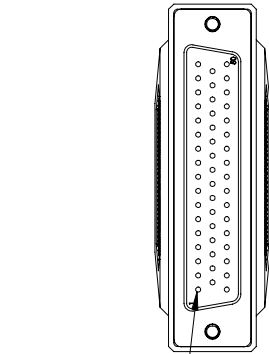
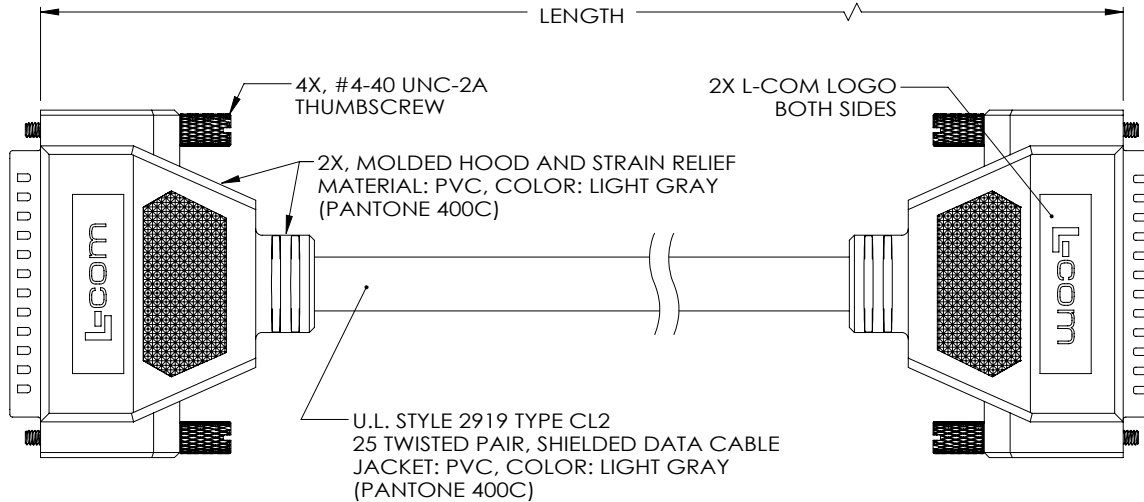

"P2"

2X MALE 50-PIN D-SUB CONNECTOR



MODEL NO.	NOTE
CSMN50MM-xxM	WHERE xxM = LENGTH IN METERS (LENGTHS OUT OF THE STANDARD ONES LISTED IN WEBSITE CAN BE AVAILABLE THROUGH CUSTOMIZATION)

WIRING MAP

"P1"		"P2"	
PAIR	PIN	PAIR	PIN
1	1	14	27
2	2	15	28
3	3	16	29
4	4	17	30
5	5	18	31
6	6	19	32
7	7	20	33
8	8	21	34
9	9	22	35
10	10	23	36
11	11	24	37
12	12	25	38
13	13		39
14	14		40
15	15		41
16	16		42
17	17		43
18	18		44
19	19		45
20	20		46
21	21		47
22	22		48
23	23		49
24	24		50
25	25		
26	26		

CABLE SHIELD DRAIN WIRE IS CONNECTED TO SHELL OF EACH DB50

NOTES:

1. CABLE ASSEMBLY SHALL BE TESTED FOR CONTINUITY.
2. CABLE ASSEMBLY SHALL BE INDIVIDUALLY PACKAGED IN ACCORDANCE WITH L-COM PACKAGING SPEC. PS-0031.

REGULATORY COMPLIANCE:

EU RoHS DIRECTIVE (MOST RECENT RELEASED VERSION)

UNLESS OTHERWISE SPECIFIED LEADING DIMENSIONS ARE INCHES DIMENSIONS IN [] ARE MILLIMETERS	
TOLERANCES:	
X = ±.2 [5]	FRACTIONS ± 1/32
XX = ±.02 [0.5]	ANGLES ± 1°
.XXX = ±.005 [0.13]	
CABLE LENGTH TOLERANCES:	
≤12 [305]	±.1 [25] / -0
>12 [305] ≤ 60 [1524]	±.2 [51] / -0
>60 [1524] ≤ 120 [3048]	±.4 [102] / -0
>120 [3048] ≤ 300 [7620]	±.6 [152] / -0
>300 [7620]	±.8% / -0
ALL DIMENSIONS ARE FOR REFERENCE ONLY AND SUBJECT TO CHANGE WITHOUT NOTICE. UN-DIMENSIONED/NON-CRITICAL FEATURES MAY VARY IN SIZE AND LOCATION. COLORS MAY VARY.	



Website: www.L-com.com
Phone: 1.800.341.5266 | 1.978.682.6936

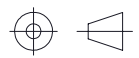

INTERPRET ALL DIMENSIONS AND TOLERANCES PER ASME Y14.5

SCALE	SHEET
NONE	1 OF 1

DESCRIPTION				
CABLE, DB50M/M MOLDED				
SIZE	CAGE CODE	DRAWN BY	ITEM NO.	REV
A	43321	SLI	CSMN50MM-xxM	B

THE INFORMATION CONTAINED IN THIS DRAWING IS THE SOLE PROPERTY OF INFINITE ELECTRONICS, INC. ANY REPRODUCTION IN PART OR WHOLE WITHOUT THE WRITTEN PERMISSION OF INFINITE ELECTRONICS, INC. IS PROHIBITED. THESE COMMODITIES, TECHNOLOGY OR SOFTWARE WERE EXPORTED FROM THE UNITED STATES IN ACCORDANCE WITH THE EXPORT ADMINISTRATION REGULATIONS. DIVERSION CONTRARY TO U.S. LAW PROHIBITED.

6

5

4

3

2

1